

HK-93-II

Specifications

1 Weight (body)	: 8.5 KG
Accessory	: 3.8 KG
2.Machine dimension	: 420×290 ×250H (mm)
3.Speed control	: SCR control
4.Power source	: AC 220V±10%
5.Cutting speed	: 50 ~ 1000mm/min
6.Cutting thickness	: 5-30mm
7.Bevel angle	: 0 ~ 45°
8.Diameter of the cutting circle	: Φ50 ~ Φ550mm
9.Tip	: G02(for acetylene)orG03(for propane)
10.Motor	: DC110V 50HZ 30W 4200RPM

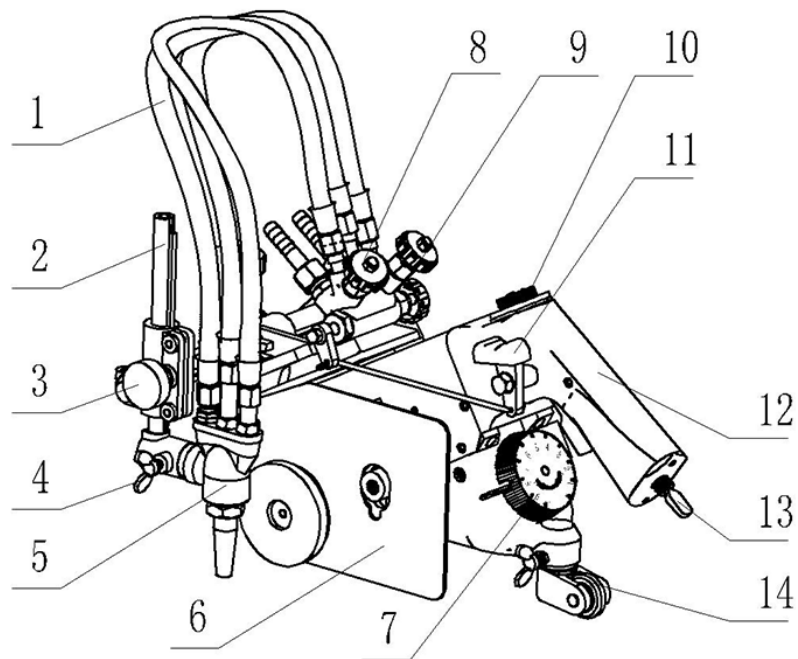

<p>1. Adjusting handle: When traversing the handle, the torch moves left or right.</p>	<p>8. Adjusting handle: Adjust the moving speed.</p>
<p>2. adjusting handle: When traversing the handle, the torch moves up or down.</p>	<p>9. Power socket</p>
	<p>10. Cutting oxygen switch.</p>
<p>3. Contrate gear rack</p>	<p>11. Gas delivery hose.</p>
<p>4. Thermal baffle: Stop the thermal diffuse outside.</p>	<p>12. Normal-reverse switch.</p>
<p>5. balance-weight</p>	<p>13.Universal wheel</p>
<p>6. two-port valve: Adjust the gas-flow rate.</p>	<p>14. cutting nozzle</p>
<p>7. On-off handle: Hold tightly the machine is off and hold loosely the machine is automatically on.</p>	