

HK-93

Specifications

| | |
|----------------------------------|--------------------------------------|
| 1 Weight (body) | 10.5KG |
| Accessory | 3.8 KG |
| 2.Machine dimension | 460 mm×360 mm×240 mm |
| 3.Speed control | SCR control |
| 4.Power source | AC 220V±10% |
| 5.Cutting speed | 50 ~ 1000mm/min |
| 6.Cutting thickness | 5-30mm |
| 7.Bevel angle | 0 ~ 45° |
| 8.Diameter of the cutting circle | Φ50 ~ Φ550mm |
| 9.Tip | G02(for acetylene)orG03(for propane) |
| 10.Motor | DC110V 50HZ 30W 4200RPM |

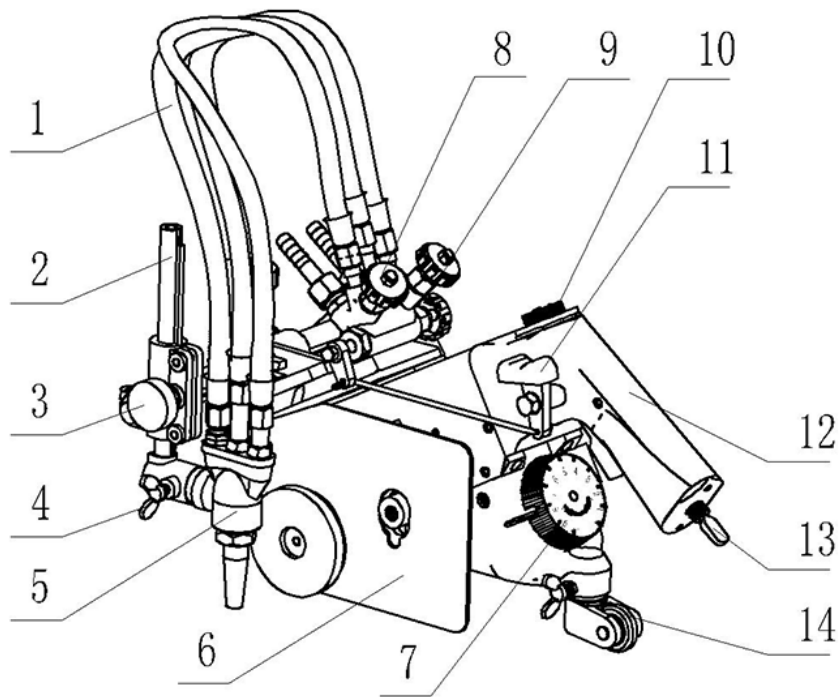

| | |
|---|---|
| 1. Adjusting handle: When traversing the handle, the torch moves left or right. | 8. Adjusting handle: Adjust the moving speed. |
| 2. adjusting handle: When traversing the handle, the torch moves up or down. | 9. Power socket |
| | 10. Cutting oxygen switch. |
| 3. Contrate gear rack | 11. Gas delivery hose. |
| 4. Thermal baffle: Stop the thermal diffuse outside. | 12. Normal-reverse switch. |
| 5. balance-weight | 13. Universal wheel |
| 6. two-port valve: Adjust the gas-flow rate. | 14. cutting nozzle |
| 7. On-off handle: Hold tightly the machine is off and hold loosely the machine is automatically on. | |