

## CG1-30A

### Specifications

<b>1.Weight</b>	<b>: 25.5 kilograms</b>
<b>2. Machine dimension</b>	<b>: 430mm×230mm×280mm</b>
<b>3. Speed control</b>	<b>: Integrated circuit</b>
<b>4. Power source</b>	<b>: AC 220V 50HZ</b>
<b>5. Cutting speed</b>	<b>: 50 ~ 750mm/min</b>
<b>6. Cutting thickness</b>	<b>: 8-100mm</b>
<b>7.Groove angle</b>	<b>: 0-45 degree</b>
<b>8.Diameteral of cutting circle</b>	<b>: <math>\varnothing</math>200-<math>\varnothing</math>2000mm</b>
<b>9.Tip</b>	<b>: G02 1#、 2#、 3#</b>
<b>10.Motor</b>	<b>: DC 110V 0.5A 30W 3600-4600r/min</b>
<b>11.Convex guide rail</b>	<b>: 6Kg(2pc)</b>
<b>12.Concave guide rail</b>	<b>: 8Kg 1.8m/pc or 11Kg 1.2m/2pc</b>

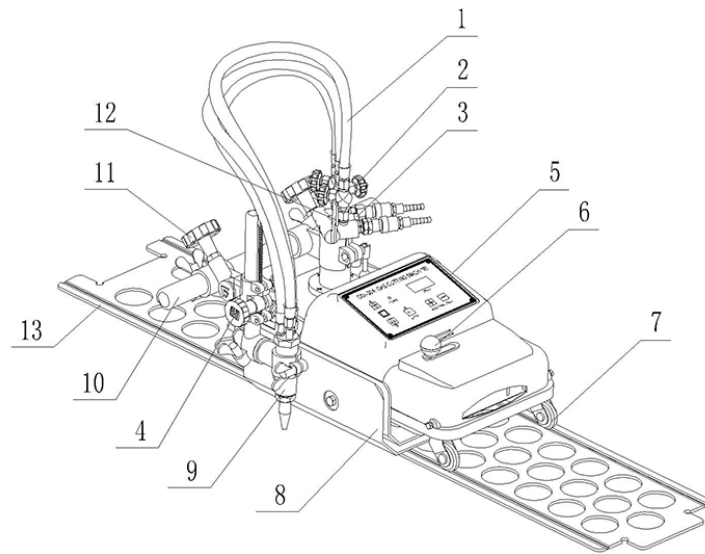

1. Hose: Connect them between distributor and torch. The three hoses are used individually for fuel gas, preheating oxygen and cutting oxygen.

2. Gas two-way valve: To adjust gas-flow rate.

3. Gas distributor.

4. Hand wheel: To adjust the up-down distance of torch by the wheel.

5. Main machine.

6. Clutch hand knob

7. Universal wheel

8. Thermal baffle: To prevent the heat diffusing into the inner of machine.

9. Torch body.

10. Cross gear rack

11. Cross hand wheel: To adjust the horizontal distance of torch on cross bar

12. Fast switch knob: The knob is divided into three grapes: "close", "preheating oxygen" and "cutting". It will close all the gas valves if the knob is on the "close"

position.

13. Guide rail: There are two types: convex wheel and concave wheel.