

CG1-30K

Specifications

1.Weight	12.5 kilograms
2. Machine dimension	435 mm×210 mm×240 mm
3. Speed control	silicon control
4. Power source	AC 220V±10% 50HZ
5. Cutting speed	50 ~ 4500/mm/min
6. Cutting thickness	Option as per cutting required
7.Groove angle	0-45 degrees
8.Diameteral of cutting circle	ø200-ø2000mm
10.Motor	DC 110V 50HZ 30W 4200r/min

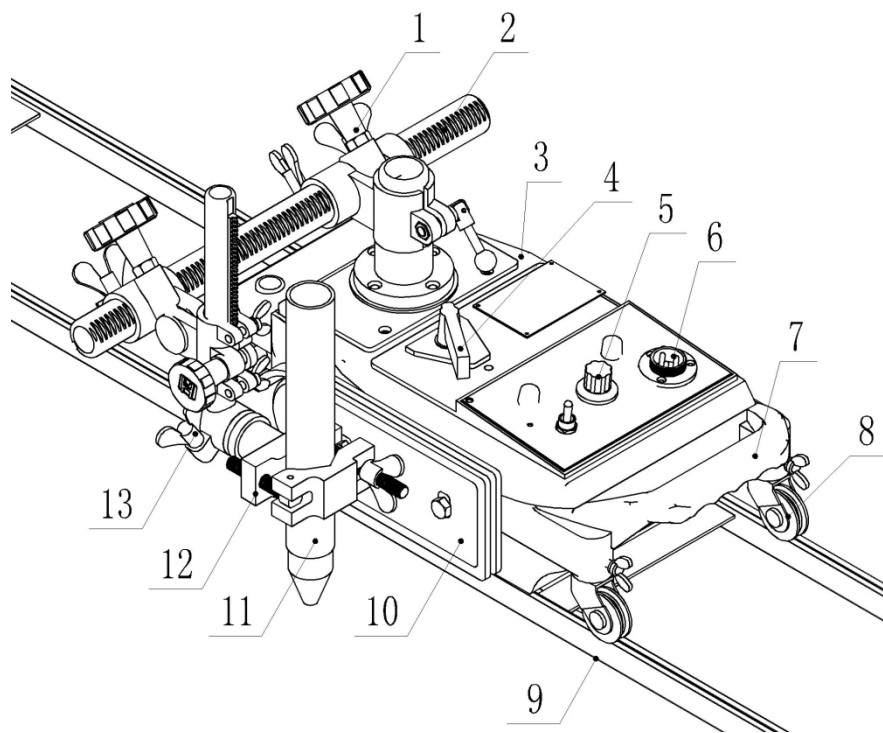

1.left and right moving seat	7.portable handle
2.cross moving rack	8.universal wheel
3.main body	9.guide
4.clutch lever : Align the end of lever with	10.insulation board : prevent the heat
“STOP” is detach.Align the end of	produced by cutting from going
lever with “START” is combination.	into the inner of machine.
5.Speed control knob: The speed is increased from	11.plasma torch
“0”to“10”; The speed is decreased from	12.plasma holder
“10”to“0”	
6.power outlet	13.up and down moving assembly of torch